



# A Day of SEND

18th October 2023

9am - 9pm

@ Priory Community School



This is the official Event Programme  
for parents, carers, family members  
& professionals for  
A Day of SEND



# North Somerset Parent Carers Working Together



We are NSPCWT, the local parent carer forum. We aim to improve the service, provision and the quality of life for children and young people with disabilities and additional needs by being the collective voice of parent carers and a strategic partner for the Local Authority, Education and Health.

We facilitate fully funded training, offer regular coffee meet ups either in school settings or at a general location such as our base at The Firs in Weston-super-Mare plus wherever possible, we provide wellbeing opportunities for our community.

The majority of our team are Parent Carers too and have walked the same paths as yourselves. We are each still on our journeys, learning and evolving as we go. Our passion comes from our hearts and we strive to make change, bring together a much needed community and offer support plus many cups of tea.

Find full details inside of our attendees for the day including information on training workshops, exhibitors, presentations and more...

We hope you have a fantastic day, gaining support, advice, knowledge and meeting others on a similar journey to yours.

# Contents

Key Note Presentations	3 - 5
Exhibitors	6 - 7
Map of the Event	8 - 9
Training Timetable	10 - 17
Drop-in Clinics	18
Notes Page	19
Parent Carer, Children & Young People Activity Workshops	20 - 21

**This is our local stakeholder event for the Special Educational Needs and Disabilities Community in North Somerset**

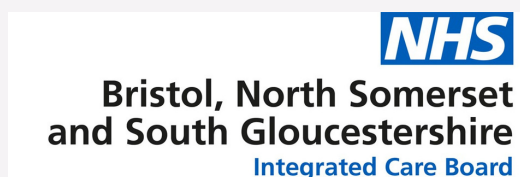

# Introducing our Key Note Speakers

## Catrina Lowri



Catrina founded Neuroteachers to help educational settings work with their autistic and neurodivergent learners to find simple solutions for inclusive practice.

Catrina is neurodivergent herself, having the dual diagnosis of dyslexia and bipolar disorder. She is a qualified special needs teacher and an experienced SENCO and advisory teacher.

In her popular keynote speech, Catrina talks about how the concept of neurodiversity grew from a fringe idea amongst online communities of autistic and ADHD adults to an umbrella term, used to describe the infinite variety of minds and brains we find amongst humanity. Catrina includes examples from her lived experience as a neurodivergent teacher and the latest research and thinking from this exciting social movement. She also discusses simple, practical ideas about how you can support your neurodivergent child or pupil to thrive in a neurotypical world.

Key note speech: 'Celebrating Neurodiversity' at 5.45pm in the Auditorium.

Catrina has an exhibitors stall (no.52) & is running a Clinic plus three Training Workshops. Please find these details on the Timetable (pgs 9 - 16).

## Peter Wharmby



"After being diagnosed as autistic at the age of 34 in 2017, I have immersed myself in working to improve autistic awareness, acceptance and making the world a more suitable place for the neurodivergent community. I am most active on Twitter, where I go by the handle '@Commaficionado' and on YouTube, where my channel is approaching 3000 subscribers. My first book, What I Want to Talk About, was published by Jessica Kingsley Publishers in September 2022, and my second book, Untypical, was published by HarperCollins in March 2023. I have also written a number of articles, interviews and book chapters, and appeared on BBC Radio 2. I am a former secondary English teacher and a father-of-one."

Peter's speech is about how the world is not set up for autistic people. In this talk, Pete will explain some of the ways things could change for the better for autistic people of all ages.

Key note speech: 'Untypical - How the World Could be Better for Autistic People' at 11.15am in the Auditorium.



# Loren Snow



Loren Snow, is an autistic autism consultant with over ten years experience teaching people to understand autism. They have delivered training to tens of thousands of parents of autistic children, autistic adults, and NHS staff.

They work with NHS England teaching NHS staff and reviewing autistic patients' care in psychiatric hospitals on Care, Education, and Treatment Reviews and as a Tier 2 Lead Trainer on the Oliver McGowan Mandatory Training.

They also work with many organisations from transporting bodies to public health, employers, schools, and charities and regularly speak at public events like conferences.

You can find out more about them and the work they do on their website: [www.lorensnow.com](http://www.lorensnow.com)

"The keynote will be about my journey growing up autistic, what I learned worked for me along the way, and how those strategies can help your children".

Key note speech: 'My Journey Growing Up Autistic' at 7pm in the Auditorium.

Loren has an exhibitors stall (no.69) & is running two Training Workshops. Please find these details on the Timetable (pgs 9 - 16).

# Jacqui Scott



"I have been in education for many years now. My various pursuits and projects have taken me overseas to teach in Europe and Southeast Asia which were both wonderful and challenging experiences. Closer to home, I trained to teach French and German and loved my time teaching languages. I was lucky to be given the opportunity to train as SENDCo and worked in the field of SEND for five years. I went on to become the Head Teacher at Worle Community School Academy in 2016. I was privileged and proud to lead the school for six and a half years and am always delighted when I see students when I am out and about; they were wonderful young people. At the beginning of 2023, I joined Education Partnerships here in North Somerset and continue my enthusiasm for working with education providers".

"How to build a strong positive relationship between professionals & parent carers" will be in the Auditorium at 8pm. She is also providing further workshops, details on the Timetable (pgs 9 - 16).

# Meet Your Local Leaders

An informal opportunity for you to ask questions, share your experiences, opinions and ideas regarding the provision of services in North Somerset for children and young people with additional needs and disabilities with the local leaders.



Drop in anytime between 6 - 8pm in room PE1

# Charlotte Pay



After many years working in healthcare and support work, Charlotte qualified as a Learning Disabilities Nurse in 2019.

While training, Charlotte was hand-picked to represent Learning Disability Nursing in a team commissioned by NHS England to support individuals in long term segregation, specialising in transition from CAMHS to adult services, and saw great success in treatment and recovery.

She spent 3 years working for South London and Maudsley NHS foundation trust in behavioural developmental psychology, forensic mental health, and the National Autism Unit; before abandoning her secret dreams of West End stardom and moving to Weston-super-Mare to start her family.

Charlotte has worked for the last 2 years in Acute mental health, learning many new skills as part of a vast MDT in the Avon and Wiltshire partnership NHS trust.

Charlotte talks with passion about the importance of recognising, understanding, and taking care of your own mental health and wellbeing. She looks at ways to recognise signs of burn-out and finding skills to manage and prevent overwhelm. She will consider reflective practice and other methods in taking stock of and minding your own mental health. It's time to prioritise yourself and your mental wellbeing as you put your all into supporting your children and family navigate through life.

**“Mental Health Matters - I’m talking to you” will be in the Auditorium at 2pm.**

# Exhibitors

1	Baytree School - Specialist School
2	Westhaven School - Specialist School
3	Ravenswood School - Specialist School
4	Mendip Green School - Mainstream school including 'The Cove' Autism Specialist Hub
5	Extend Learning Academies Network - Milton Park and Locking Primary School
6	Nailsea School - hub
7,8,9	Weston College
10	Priory Learning Trust - Nurseries, primary and secondary schools within the trust
11	Capital Programmes & School Organisations/Admissions Service - Education Partnerships- NSC Children's Services
12	Springboard Opportunity Group - Charity supporting children 0-5 years
13	Early Years Team - NSC
14	SEND Team - NSC
15	NEET Team - NSC
16	Autism Education Trust - NSC
17	Enhanced Provision Team - NSC
18	SEND Clubs & Activities Service (SENDCAS) NSC
19	Sitting Service and Portage - NSC
20	Virtual School - NSC
21	Children With Disabilities Team - NSC

22, 23	Family Wellbeing Parenting Team - NSC
24	Family Wellbeing Team -NSC
25	Sexual Health Commissioning/ Mental Wellbeing & Community Development Teams -NSC
26	Adult Transitions Team - NSC
27, 28	Local Offer - NSC
29	Therapies inc Speech & Language and Occupational Therapy - SIRONA
30	Community Paediatrics inc Autism- SIRONA
31	Public Health Nursing/Lifetime/ Continence Team - SIRONA
32	Paediatric Burns Outreach Team - Bristol Children's Hospital
33	Mental Health in School Teams - AWP & Off The Record - OTR
34	North Somerset Parent Carers Working Together - NSPCWT
35	SEND and You (SAY) - SENDIAS Service
36	Bridging The Gap Together!
37	LGBTQ+
38	Act4SEND
39	Ali Pennington - Makaton Trainer
40	Aurora Foxes

# Exhibitors

41	AutonoMe
42	We Work for Everyone
43	Bristol Autism Support (BAS)
44	BIBIC
45	Boost Academy and Trampolining Club
46	Brandon Trust
47	Elmtree/Elementa
48	HeartWithinYoga
49	Homestart
50	Jack Hazeldene Foundation (JHF)
51	Jigsaw Thornbury
52	K00TH
53	Neuroteachers
54	North Somerset National Autistic Society
55	North Somerset People First
56	Phil Benge - Therapeutic Counsellor
57	Platypus Training
58	Sensory Oojamabobs

59	Surround Support
60	Strawberry Line
61	Uncle Paul's Chilli Farm
62	Worthy Therapy - Play Therapy & Counselling
63	Young Carers Team - Alliance Homes
64	121Turnaround
65	RESET
66	World of Stuff Project
67	Wellspring Counselling
68	PlanIt Future
69	BakerMurray Consulting
70	Loren Snow
71	Healthwatch
72	ICB (Integrated Care Board)
73	Network Healthcare
74	A different Perspective
75	Independent communicators
76	Carers Collective
13 - 28	*NSC- North Somerset Council



# Map of the building

## Key:

-  = Activities
-  = Key Note Speeches
-  = Drop In Clinics
-  = Training
-  = Market place
-  = Main Reception / Sign in
-  = Toilets

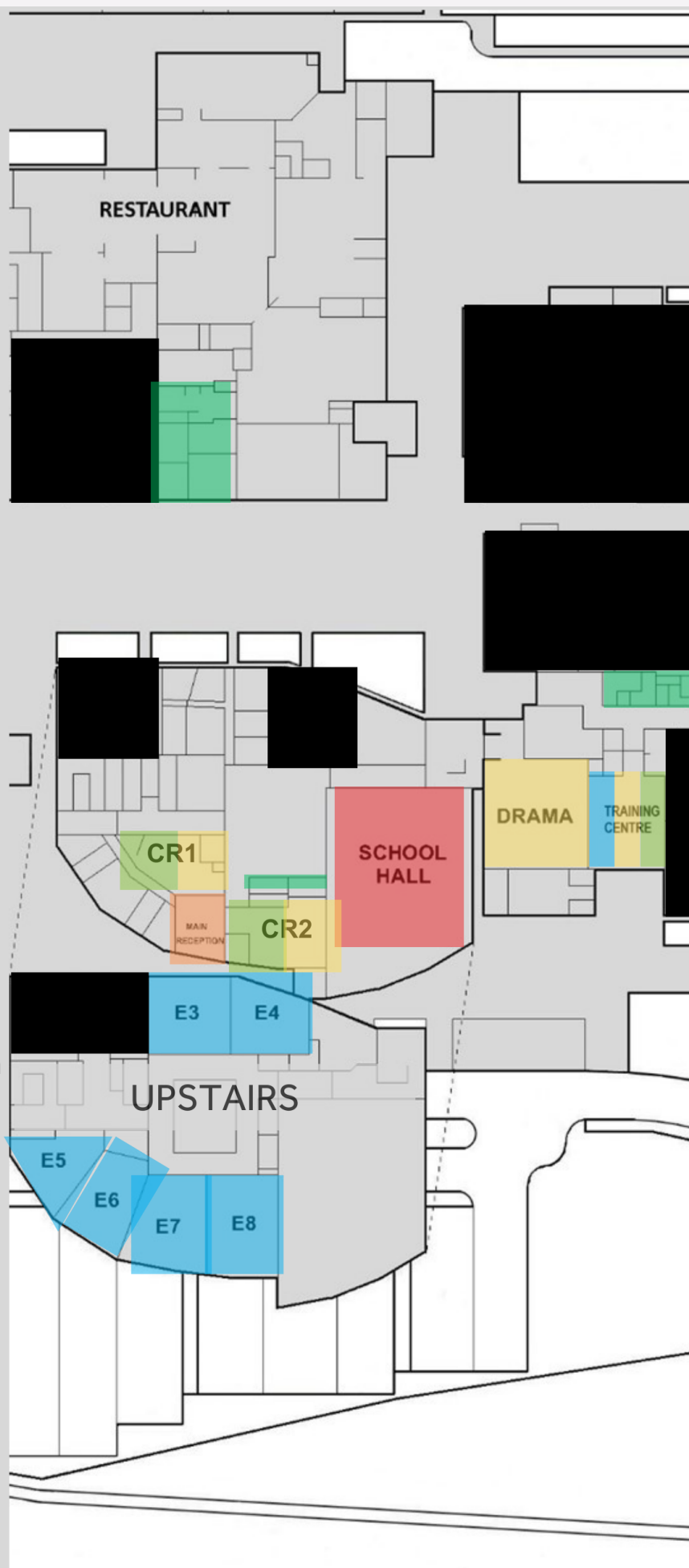

# Map of the building

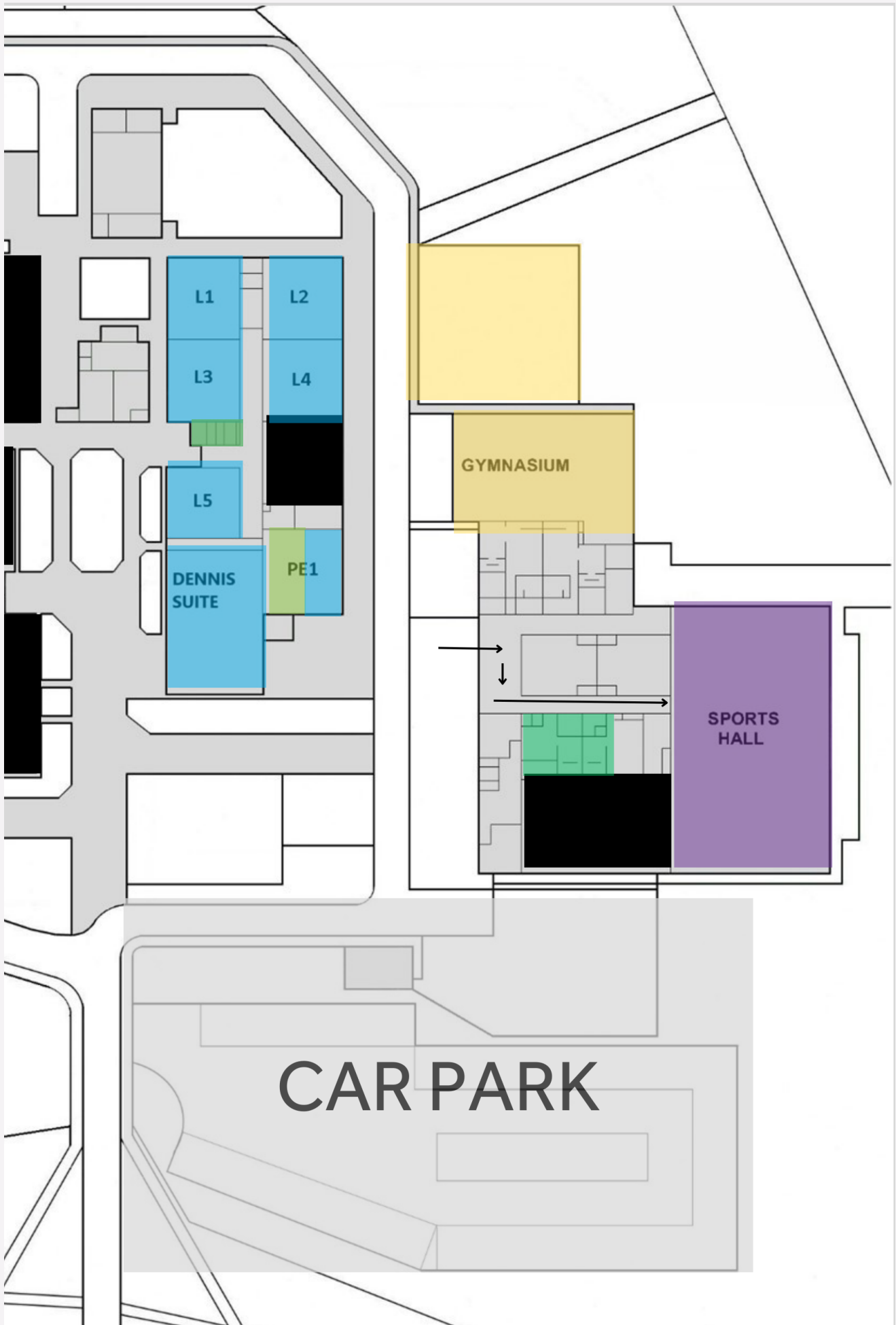

# Training Workshops Schedule

Please note, these workshops are all subject to change on the day. We will do our best to keep attendees up to date on the schedule.

Please sign up to the sessions via Eventbrite as they are bookable due to capacity, you can see more information about training on Eventbrite.

E7	09:45 - 10:45	Tracy Jones	Communicating with Neurodiverse Young People
E8	09:45 - 10:30	Early Years Team	Transition into Primary School
L3	09:45 - 10:30	Educational Psychologists	Educational Psychologists contributions to the EHCP including Q&A
E3	09:50 - 10:20	Social Care Team	Direct Payments Overview
L4	10:00 - 11:00	Corrina Wood	An introduction to Autism
AUDITORIUM	10:00 - 11:00	Catrina Lowri	Dropping The Mask - allowing your neurodiverse child to be their authentic self
L5	10:00 - 11:00	Ali Pennington	An introduction to Makaton
PE1	10:00 - 11:00	Childrens Centre's	The Family Wellbeing Team: North Somerset Children Centres and the development of Family Hubs
E5	10:15 - 10:45	Baytree School	Social Story Writing

# Training Workshops Schedule

E6	10:15 - 10:45	Sarah Evans	Visual Prompts in Early Years
L1	10:15 - 11:15	Sue Willis	Dyslexia Workshop
L2	10:30 - 11:30	Lisa Baker-Murray	How to advocate for your child
Dennis Suite	10:30 - 11:30	Loren Snow	Autism and Disordered Eating
E3	10:30 - 11:00	Social Care Team	What to expect when accessing the Front Door
E4	10:30 - 11:15	Jacqui Scott	Transition Pathway and Trauma Informed Work
TRAINING CENTRE	10:30 - 11:00	SAY	EHCP Process Explained
E8	10:45 - 11:30	Karen Jarvis	How to support Child Development through play
L3	10:45 - 11:15	Young Carers	An introduction into Young Carers



# Training Workshops Schedule

E5	10:50 - 11:20	Baytree School	Behaviour Support
E7	10:55 - 11:55	Debbie Meintjes	Sensory Processing Workshop
E3	11:10 - 11:40	Social Care Team	Overview of Family Support Workers and Social Worker Assessments
AUDITORIUM	11:15 - 12:15	Peter Wharmby	Untypical - how the world could be better for autistic people
L4	11:15 - 12:15	Rhiannon Gogh	Wills, Trusts and Planning for those with Special Needs
E4	11:20 - 12:05	Jacqui Scott	Schools and Parent Carers working together
L1	11:20 - 12.10	Lindsey Hall	Brain it with Brain
L3	11:30 - 12:15	Lauren Finn - Kooth	An introduction into Kooth and How To Access
E4	11:20 - 12:05	Jacqui Scott	Schools and Parent Carers working together
L1	11:20 - 12.10	Lindsey Hall	Project 5 resilience and wellbeing programme

# Training Workshops Schedule

L3	11:30 - 12:15	Lauren Finn - Kooth	An introduction into Kooth and How To Access
L5	11:30 - 12:30	BIBIC	Executive Functioning
E5	11:30 - 12:00	Baytree School	AAC (Augmentative and Alternative Communication) Communication
L2	11:40 - 12:40	Emma Pattinson	Parents Matter
Dennis Suite	12:00 - 13:00	Catrina Lowri	ADHD
E6	12:00 - 12:45	Special Schools	A day in the life of Special Schools
E8	12:00 - 13:00	Becky King Weston College	Inclusive workforce
E7	12:05 - 13:05	Clare Philpotts/ Vicky Bates	ASD and ADHD referral pathways and making a referral
L1	12:15 - 13:15	Sue Willis	Dyscalculia Workshop
E4	12.30 - 13.30	SEN Team	An introduction to the SEND EHC portal for parent carers

# Training Workshops Schedule

L2	13:00 - 14:00	SEN Team	Transitioning to Secondary School
L4	13:00 - 14:00	Autonome	Blending human support and technology to support learners to develop and maintain life skills with AutoNoMe
E6	13:00 - 13:30	Kim Kettle and Kate Campbell	Supporting schools where there is either a risk of placement breakdown or a significant transition taking place for a young person
E7	13:15 - 14:15	Nursing team	Ready to Learn
Dennis Suite	14:00 - 15:00	Corrina Wood	Autism in Girls
AUDITORIUM	14:00 - 15:00	Charlotte Pay	Mental Health Matters - I'm talking to you
L5	14:15 - 14:45	Lizzie Evans	Burns Prevention and First Aid
E6	15:30 - 16:00	Sarah Evans	Visual Prompts in Early Years
E7	16:00 - 17:00	Tracy Jones	Communicating with Neurodiverse Young People
Dennis Suite	16:00 - 17:00	Catrina Lowri	Anxiety and Additional Needs
L2	16:30 - 17:30	Lisa Baker-Murray	How to advocate for your child

# Training Workshops Schedule

L4	16:30 - 17:30	Corrina Wood	Autism and Co-Occurring Conditions
E3	16:30 - 17:00	Social Care Team	Direct Payments Overview
PE1	16:45 - 17:45	Childrens Centre's	The Family Wellbeing Team: North Somerset Children Centres and the development of Family Hubs
E5	17:00 - 17:30	Baytree School	Social Story Writing
E7	17:10 - 18:10	Debbie Meintjes	Sensory Processing Workshop
E3	17:10 - 17:40	Social Care Team	What to expect when accessing the Front Door
L5	17:15 - 18:15	Ali Pennington	An introduction to Makaton
Dennis Suite	17:15 - 18:15	Loren Snow	Autism and Disordered Eating
L1	17:30 - 18:15	Lindsey Hall	Brain it with Brian
L3	17:30 - 18:15	Educational Psychologists	Educational Psychologists contributions to the EHCP including Q&A
E4	17.30 - 18.30	SEN Team	An introduction to the SEND EHC portal for parent carers



# Training Workshops Schedule

E8	17:30 - 18:30	Early Years Team	Transition into Primary School
TRAINING CENTRE	17:30 - 18:00	SAY	EHCP process explained
E5	17:40 - 18:10	Baytree School	Behaviour Support
L2	17:45 - 18:45	Emma Pattinson	Parents Matter
E3	17:45 - 18:15	Social Care Team	Overview of Family Support Workers and Social Worker Assessments
AUDITORIUM	17:45 - 18:45	Catrina Lowri	Celebrating Neurodiversity
E6	18:00 - 19:00	Sarah Evans	Small Steps Approach
L4	18:00 - 19:00	Autonome	Supporting neurodivergent people into employment and beyond with a blend of human support and technology
E5	18:20 - 18:50	Baytree School	AAC (Augmentative and Alternative Communication) Communication
E7	18:20 - 19:20	Clare Philpotts/ Vicky Bates	ASD and ADHD referral pathways and making a referral
L1	18:30 - 19:30	Sue Willis	Dyslexia Workshop

# Training Workshops Schedule

L3	18:30 - 19:00	Young Carers	An introduction into Young Carers
Dennis Suite	18:30 - 19:30	Corrina Wood	Autism in Girls
L2	19:00 - 20:00	SEN Team	Transitioning to Secondary School
E4	19:00 - 19:45	Jacqui Scott	Transition Pathway and Trauma Informed Work
E6	19:00 - 19:30	Kim Kettle and Kate Campbell	Supporting schools where there is either a risk of placement breakdown or a significant transition taking place for a young person
AUDITORIUM	19:00 - 19:45	Loren Snow	Loren Snow: My journey growing up autistic
E8	19:10 - 19:40	Karen Jarvis	How To Support Child Development Through Play
L5	19:15 - 20:00	BIBIC	Workplace Training Programme 18-25 year olds
TRAINING CENTRE	19:30 - 20:00	SAY	Empowering Children and Young People
E7	19:30 - 20:30	Public Health Nursing team	Ready To Learn
AUDITORIUM	20:00 - 20:45	Jacqui Scott	How to build a strong positive relationship between professionals & parent carers

# Clinics

An opportunity to bring along any questions you may have around the subject.

Please sign up at the relevant stall if applicable.

Jan Eastwood	10-12pm Room: CR1	Disability Living Allowance (DLA)	Jan Eastwood is a SEN teacher and has a qualification in teaching children with dyslexia. She has experience as a SENCO, a family support worker and is a general adviser at North Somerset Citizens Advice. She is trained to help with DLA and PIP forms.
Sue Willis	2 - 3pm Room: CR1	Dyslexia, Dyspraxia, and Dyscalculia	Sue Willis from Act4SEND provides advice and support for schools to improve the provision for pupils with special educational needs and disabilities. If you have questions for anything related to dyslexia, dyspraxia, and dyscalculia, then this is the clinic for you.
Catrina Lowri	2.30 - 3.30pm Room: CR2	Neuro-diversity	Catrina Lowri founded Neuroteachers. She helps educational settings work with their autistic and neurodivergent learners to find simple solutions for inclusive practice. Catrina has a wealth of knowledge and is running a clinic where you can ask any questions on all neurodiversities.
Rhiannon Gogh	1.30 - 2.30pm Room: CR2	Wills & Trusts	Rhiannon Gogh is a Chartered Financial Advisor. How will you ensure that your child is looked after when you're no longer here? How will you give them the financial support and protection they need? Rhiannon can help you with this!
SEND & YOU -SAY	12 - 2PM Room: TRAINING CENTRE	SEN Law	SEND & You are the local Special Educational Needs and Disabilities Information Advice and Support Services (SENDIAS) for North Somerset. Their drop in clinic will be open for anyone that has any questions related to their child's schools, Educational Health Care Plans and the entire process within this.
Weston College	9 - 10am and 1 - 2pm Room: CR1	Education	If you have a young person attending or due to attend Weston College pop in to chat with the team who will be able to offer guidance and advice on what they are able to offer.

# Notes



# Activity Workshops

## Edy - Heart Within Yoga

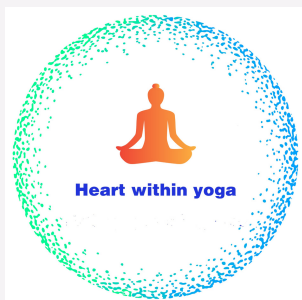

Edy will be running two Parent Carer Yoga Sessions at 1 - 2pm and 7 - 8pm & one Child and Young Person Session at 5 - 6pm.

Room **DRAMA**

We are passionate about delivering Therapeutic yoga for children and young adults with special needs. We have a simple vision to help others, especially those with additional needs, to break the physical and mental boundaries and live life to the fullest. Heart Within Yoga goes beyond traditional yoga practices by integrating sensory and visual resources, modelling and modifying yoga poses, social stories and creative games. We pride ourselves on being a unique company that helps to unlock the true potential that resides within every child.

## Uncle Paul's Chilli Farm



Uncle Paul's Chilli Farm will be running a Chilli Workshop for everyone.

Room **DRAMA**

3 - 4pm

Uncle Paul's Chilli Farm provides a unique environment where young people and adults, who may have experienced social disadvantage or barriers to learning or employment, can enjoy an alternative environment in which to learn and develop new skills, experience and qualifications needed for successful and sustainable employment.

## Bridging The Gap Together!



Bridging The Gap Together will be running two activity workshops for young people with board games.

**TRAINING CENTRE**

3 - 5pm and 6.15 - 7.15pm

Bridging the Gap Together! is an independent Community Interest Company, our aim is to provide a wide range of workshops for parents/carers of children as well as young people with complex needs or disabilities. This could include mental health needs, learning difficulties, sensory or communication impairment, emotional and behavioural difficulties, and/or on the Autistic Spectrum.

## JHF Youth Charity



Staff from JHF will be providing activities for young people such as crafts, and giant jenga.

Room **CR1**

4 - 8pm

The Jack Hazeldine Foundation empowers & inspires young lives through bespoke mentoring packages. Their vision is to ensure that every child regardless of their background achieves their unique potential, goes on to lead a happy, successful life and makes a positive contribution to their community.

# Activity Workshops

## Off The Record - OTR



Off The Record will have a Youth Corner for young people which will be a chilled out creative space. They will have some information around their services, a creative activity and some mindfulness colouring.

Room **CR2**

6 - 8pm

OTR is a mental health social movement by and for young people aged 11-25 in North Somerset. They run Drop in Hubs, Resilience Labs for Young Adults and Teens, Self-help space, Wellbeing Walks, Resilient Parenting, 1:1 Therapies and workshops such as Mind Aid and Shameless.

## Play Wild CIC



Play Wild will be based **outside** in the green with a forest school set up for children and young people to come and try.

All Day

Outdoor Play and Forest School – PLAY WILD C.I.C. is an outdoor education and play provider in the Weston-super-Mare area.

We run a variety of outdoor education and Forest School sessions, attend events and organise parties for early years and primary aged children and can tailor an event to your needs.

## Cricket Super 1s



An accessible club for cricket lovers will be available in the **Gymnasium** or outside (weather dependant) for year 7's and up to try cricket out.

4pm - 7pm

Super 1s is a cricket-based programme run throughout Somerset, giving young people with disabilities the opportunity to play cricket regularly. The aim of the programme is to use cricket as a tool for participant's personal development. Super 1s incorporate a series of different activities developing throwing, catching and ball striking skills. During these sessions participants get the opportunity to try new activities, meet new people and explore new environments.

## Gympanzees



Gympanzees will be available with sensory equipment for children and young people to try in the **Gymnasium**.

All Day

"Our vision at Gympanzees is that every disabled child and young person in the UK can enjoy a life filled with exercise, play and friendship.

Our mission is to deliver multiple fully inclusive leisure facilities that are easily accessible for disabled children, young people and their families; meeting exercise, play and social needs."



# Thank you for attending and supporting our Event.

This is the largest event we have facilitated. Our aim is  
to provide this yearly for our SEND Community.



Please complete feedback for this  
Event to support future planning.  
Many thanks



Find the event at  
Priory Community School,  
North Worle,  
Weston-super-Mare, BS22 6BP.  
The car park will be a one way system,  
please use the entrance off the  
Queensway.



NSPCWT, The Firs, Parent Carer Resource Hub, 89a  
Drove Rd, Weston-super-Mare, North Somerset,  
BS23 3NX  
01934 440844